



A Program of Center for Companies That Care

Take Your Mentor to School Day Mentor Training

11.18.14



Agenda

- Welcome
- New “Expert” Segment(Discussion on the achievement gap)
- Upcoming Events
- Take Your Mentor to School Day



New “Expert” Segment

- Dr. Marvin Hoffman
- Recently retired University of Chicago professor
 - UTEP
 - Expert in urban schools, families and communities
- Vision behind structure of AIM High
- Currently working with AIM High college students

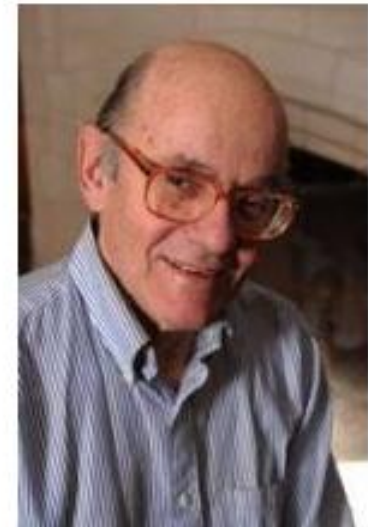



2014 ACT Scores by Race/Ethnicity from Chicago Public Schools

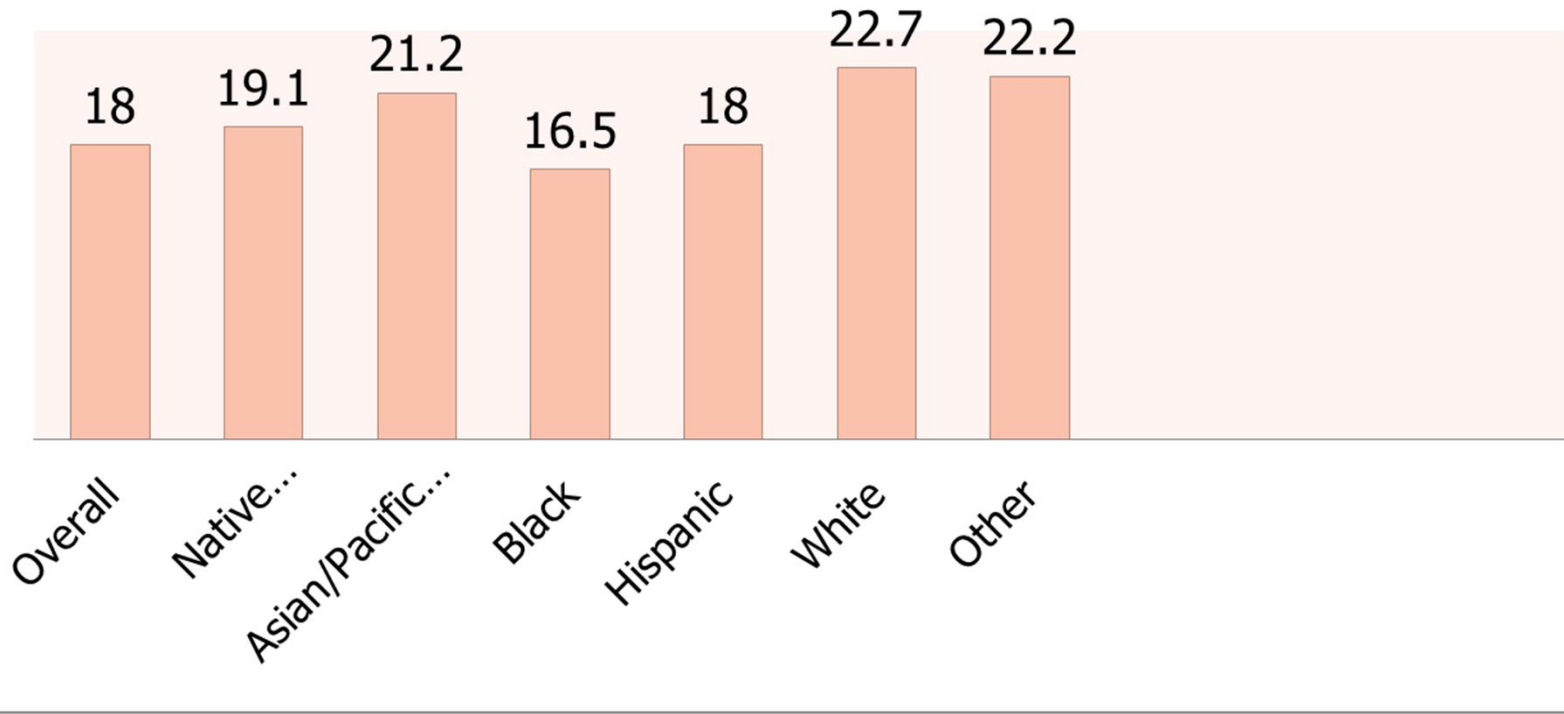



Gloria Ladson-Billings

Visit:

<http://ed618.pbworks.com/f/From%20Achievement%20Gap%20to%20Education%20Debt.pdf>

In My Opinion

Observations on life in the Occupy Era: A work in progress

2/14/07

From the Achievement Gap to the Education Debt: Understanding Achievement in U.S. Schools by Gloria Ladson-Billings

In this article, Ladson-Billings reframes the achievement gap as the educational debt. Borrowing from the language of economics she talks about the difference between a deficit and a debt. A deficit is the amount by which spending exceeds income over a particular period of time. Debt is the sum of all previously incurred deficits. It is the accumulation of gaps between spending and income. So I can be in debt even though, for one or two years time, I did not have a budget deficit.

Ladson-Billings goes on to argue that the focus on the achievement gap is akin to the focus on a budget deficit. A problem with this focus is that it does not address what she calls the "education debt." She explains this notion of education debt through looking at four dimensions: historical, economic, sociopolitical, and moral.

The historical debt is defined by a historical lack of access to formal public education for certain groups of people. African American education was forbidden during the period of enslavement, and then second-rate once that period formally ended. Education for American Indians was all about assimilation. Likewise Latina/o students have historically experienced huge disparities in their education. This history, Ladson-Billings argues, has added to the current education debt.

The economic debt is defined by historical and contemporary inequities in school funding, income disparities related to different levels of education, and then a more general wealth disparity. Inequities in school funding are well-documented and not arguable. In many cases, schools with a predominant population of students of color are funded at a lower rate than nearby schools with a predominant population of white students. It is a pattern that has persisted. Also there are patterns that relate more years of schooling with higher earnings. Over time, African American men (as an example) have earned closer to what White men earn. However, these income disparities have led to a wealth gap that cannot be made up simply by closing the earning gap.



Companies That Care

Website: companies-that-care.org

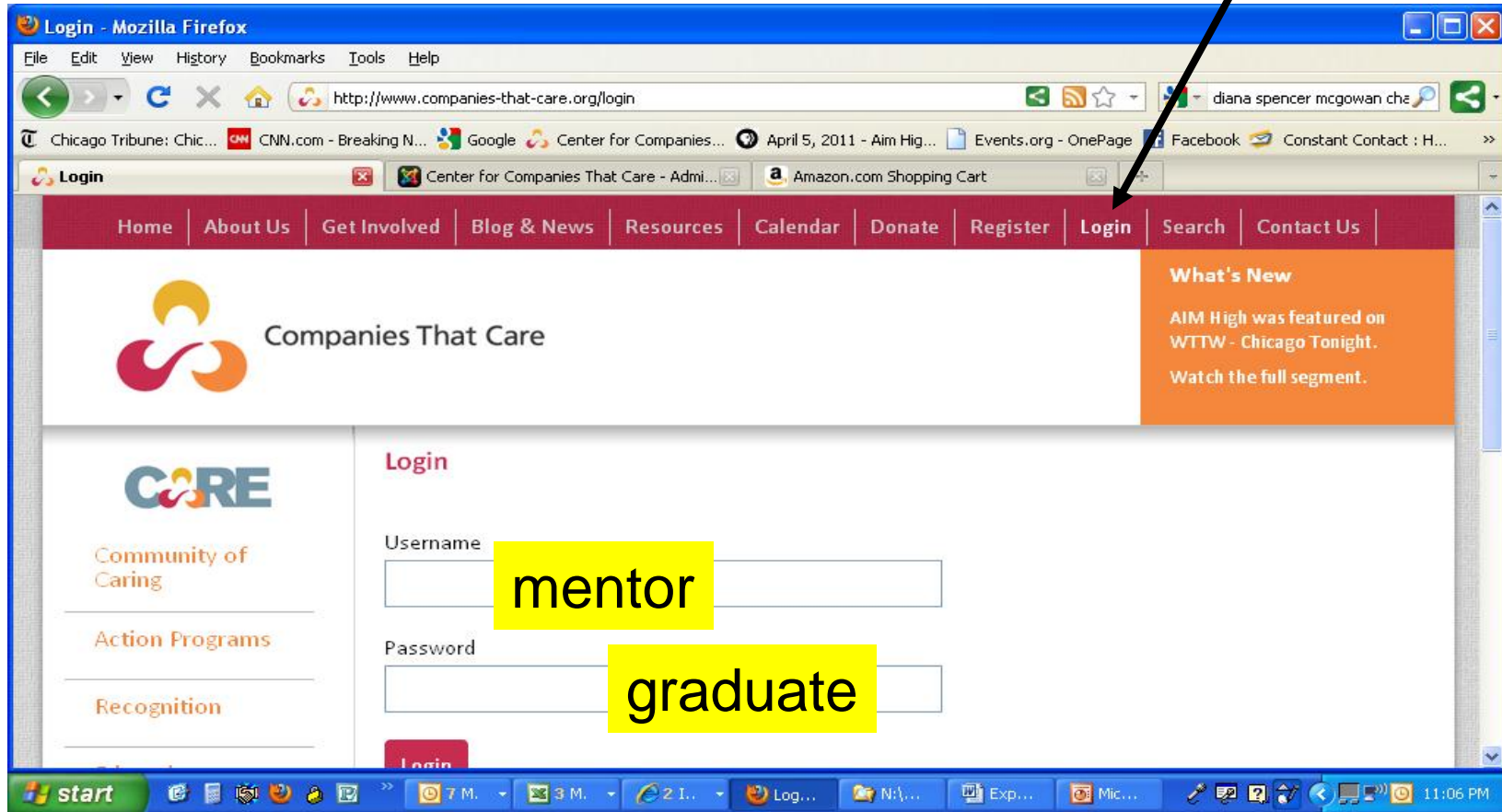



Website: Resources

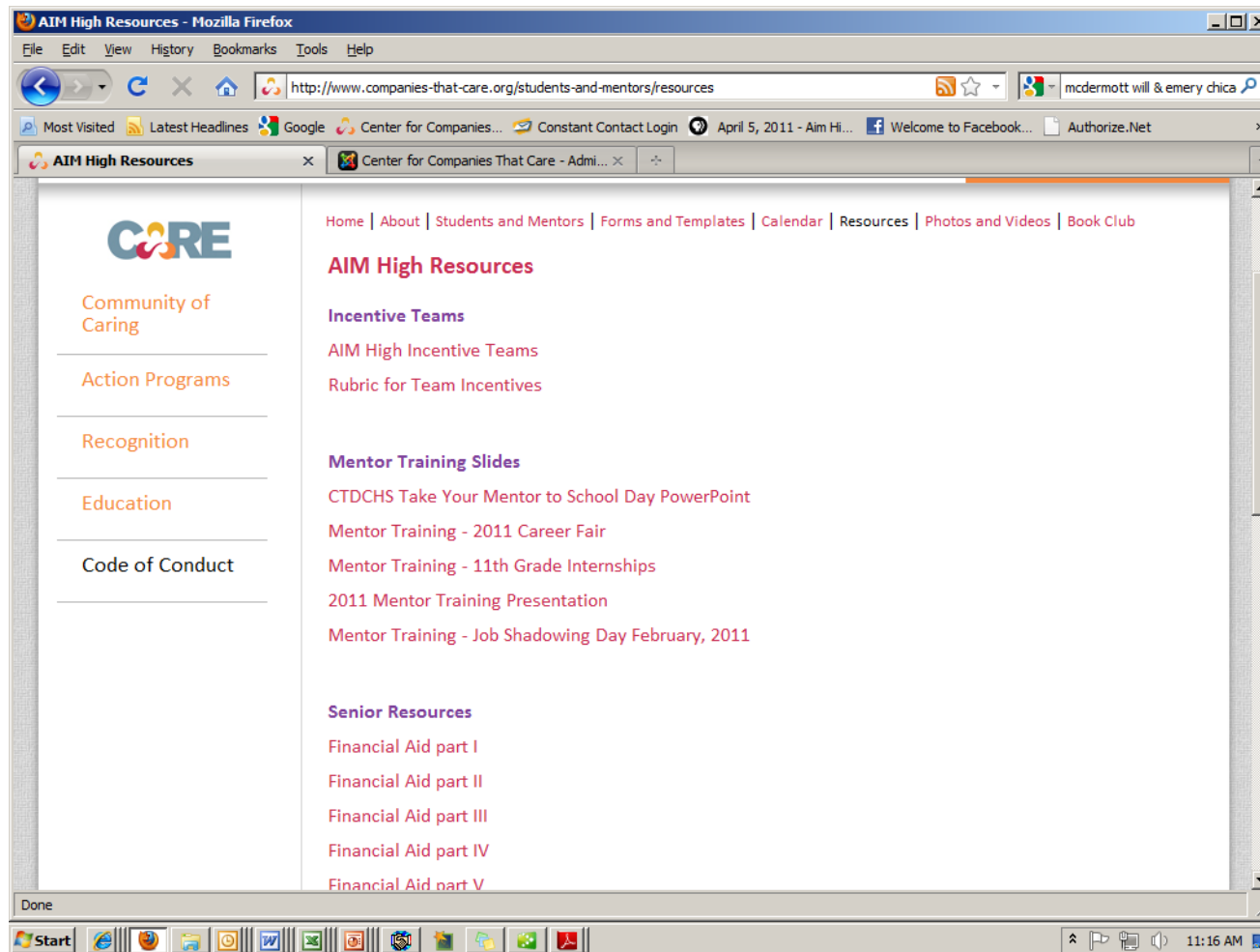



A Program of Center for Companies That Care

Upcoming Events



AIMing Higher/Senior FAFSA Completion

- **Tentative date January 2, 2015**
- **Associate Board Happy Hour**
 - December 3rd
 - A Happy Hour at Blackfinn Ameripub in Chicago's River North neighborhood.
 - Wednesday, December 3rd, from 5-7pm. Proceeds from the event will benefit Center for Companies That Care.
 - The event is being put on by the Center for Companies That Care Associate Board. More information to follow.



A Program of Center for Companies That Care

Touchpoint: Take Your Mentor to School Day

Week of December 8th, 2014



Take Your Mentor to School Day

- This event will take place several times during the week at different schools. Mentors are only expected to attend at their students' school.
 - North Lawndale College Prep: TBD
 - Ralph Ellison Charter School: Monday, December 8, TBD
 - George Westinghouse College Prep: Tuesday, December 9, TBD
 - Urban Prep - Bronzeville: Thursday, December 11th, TBD



Overview

- **What:** Take Your Mentor To School Day
- **When:** Week of December 8th for about 3 hours
- **Where:** At Students' respective schools
 - George Westinghouse College Prep - **3223 West Franklin Blvd.**
 - North Lawndale College Prep, Collins Campus - **1313 South Sacramento Blvd.**
 - Urban Prep Bronzeville – **521 E. 35th Street**
 - Ralph Ellison- **1817 W. 80th Street**
- **Who:** Mentors, Students, Companies That Care, School Staff
- **Objectives:**
 - Get a feel for school environment and life of students
 - Better understanding of school objectives and where mentor support is needed
 - Spend quality time with students, meet teachers and friends
 - Kick off March to College planning
- **Register:** Use link from the MMAHM Report or email.
 - **Registration deadline is TBD**



Event Agenda

- The schools are still working on the specific itineraries, but your visit will include a variation of the schedule below. We will be emailing those out to each of the registered mentors.

Who?	When?	What?
Mentors, School Administrator (Or Students)	10-20 minutes	Tour of the School
Mentors, Principal , College Counselors, Teachers	45-60 minutes	Principals and College Counselors to conduct PowerPoint presentation discussing: <ul style="list-style-type: none">- Charter of the school- Teaching methodology- Curriculum- Resources- College-bound strategy- Answer mentors' questions
Mentors, Students	45-75 minutes	Mentors attend 1 to 2 classes with students
Mentors, Students, AIM High Staff	45 minutes	Leadership Institute (depending on school) <ul style="list-style-type: none">- Meet with students to discuss grades and debrief on event- Begin preliminary plans for March to College fundraising<ul style="list-style-type: none">- Discuss Trivia Night ticket sales

Mentors, what else do you want to hear about from the schools?



North Lawndale College Prep, Collins Campus 1313 South Sacramento Dr.

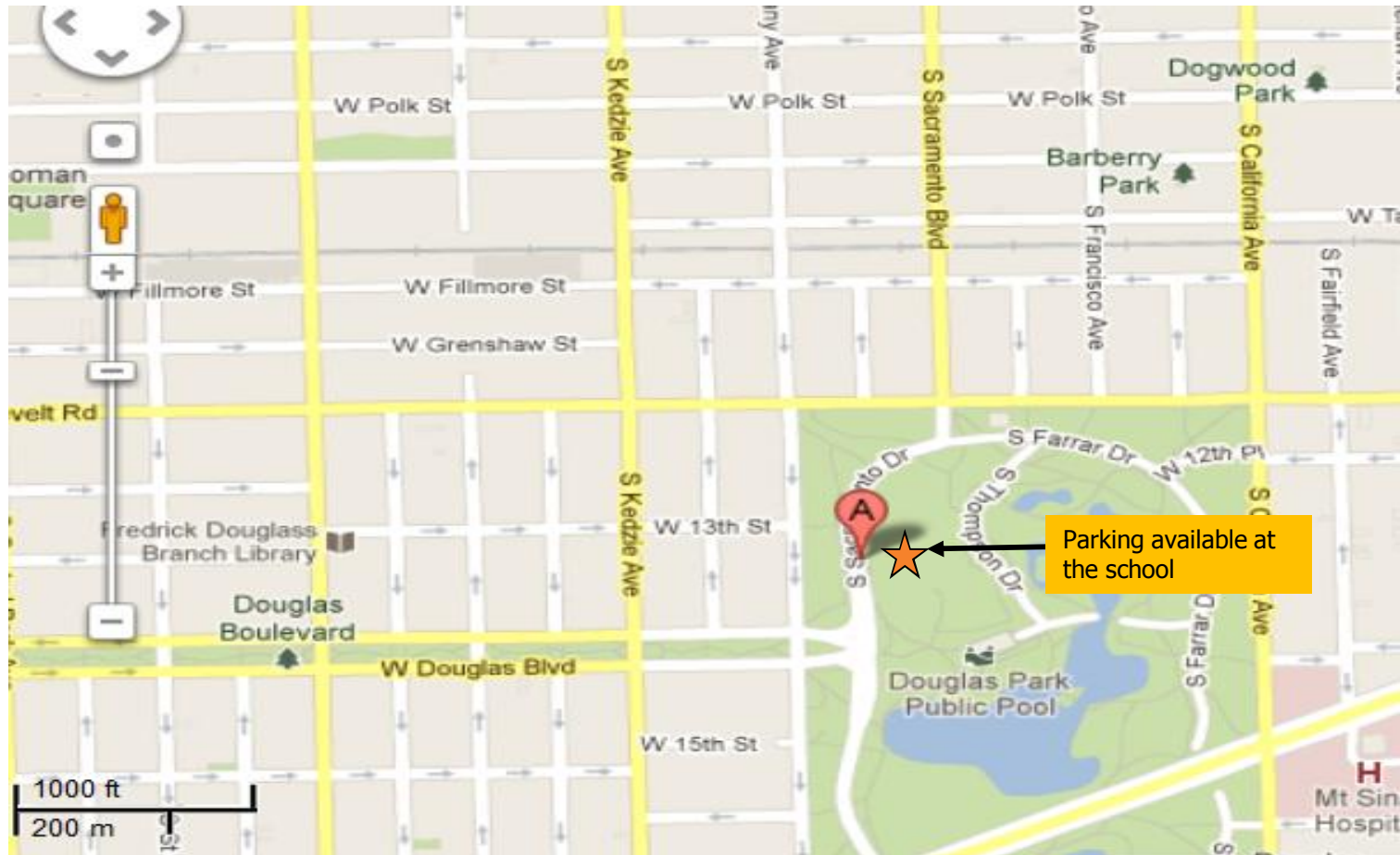



Getting There

- Address
 - **North Lawndale College Prep (NLCP)**
 - **Note: School is located inside Douglass Park**
1313 S Sacramento Dr.
Chicago, IL 60623
- Parking
 - AT **NLCP**, parking lot is right out front
- Public Transportation
 - CTA- Blue line towards Forest Park to Kedzie-Homan stop. Transfer to 82 bus on Kimball-Homan towards Central Park/31st to Homan and 13th. Walk East on 13th to school.
- Trip Details
 - Monday, December 9
 - Tentative time: 10:00am-1:00pm
- Entering the building
 - Front door faces Roosevelt Blvd.
 - Congregate in Main office, to the left of lobby
- **If lost, call Danielle**
 - 773 600 6432



George Westinghouse College Prep 3223 West Franklin Blvd.

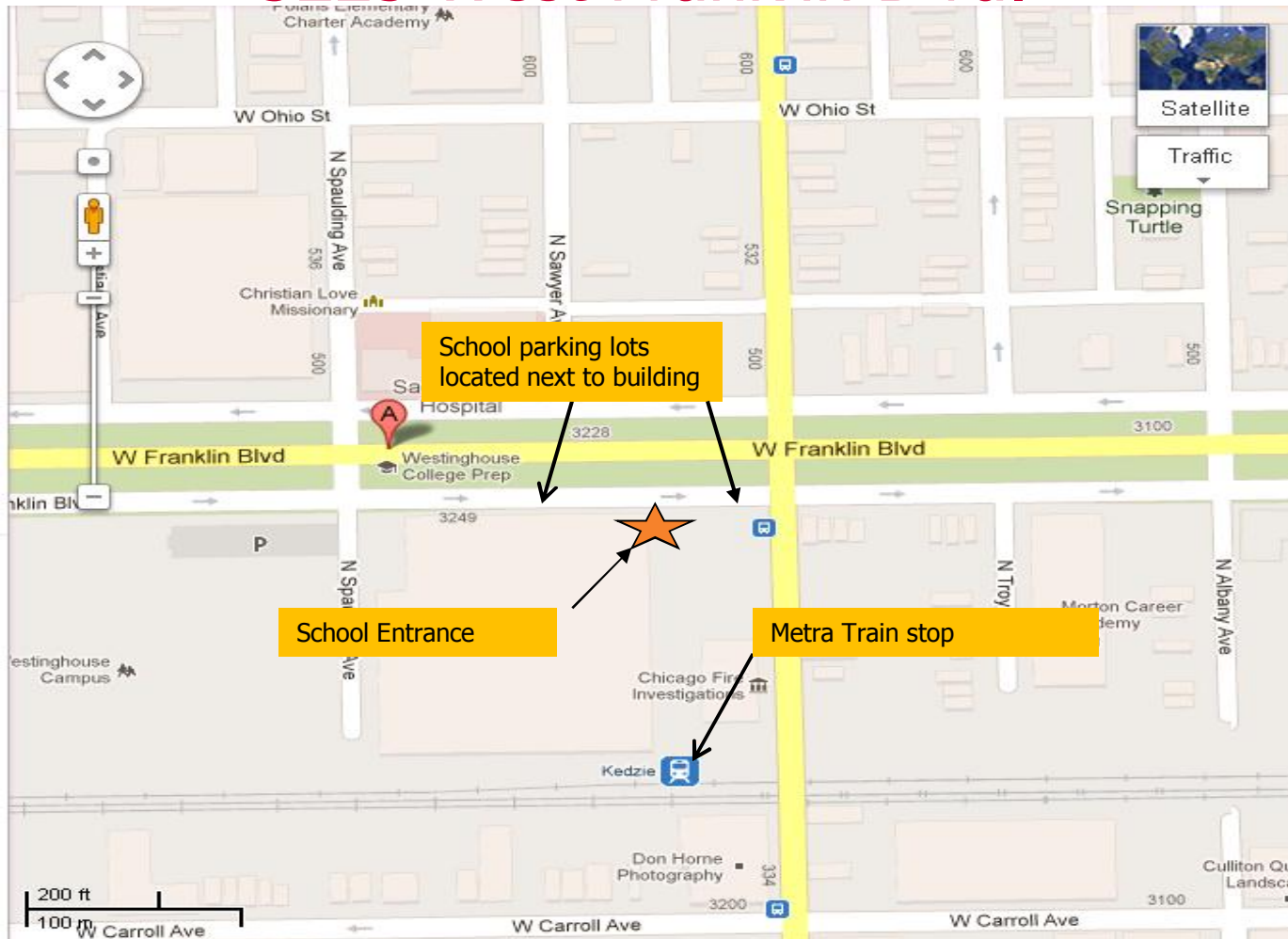



Getting There

- Address
 - **George Westinghouse College Prep**
3223 West Franklin Blvd.
Chicago, IL, 60624
- Parking
 - At **Westinghouse**, street parking available on Franklin and side streets, as well as in the parking lots adjacent to the school
- Public Transportation
 - Metra Rail- Union Pacific West, Kedzie stop
- Trip Details
 - Tuesday, December 10
 - Tentative time: TBD
- Entering the building
 - Front door faces Franklin Blvd.
 - Congregate in lobby
- **If lost, call Danielle**
 - 773 600 6432



Ralph Ellison 1817 W. 80th Street

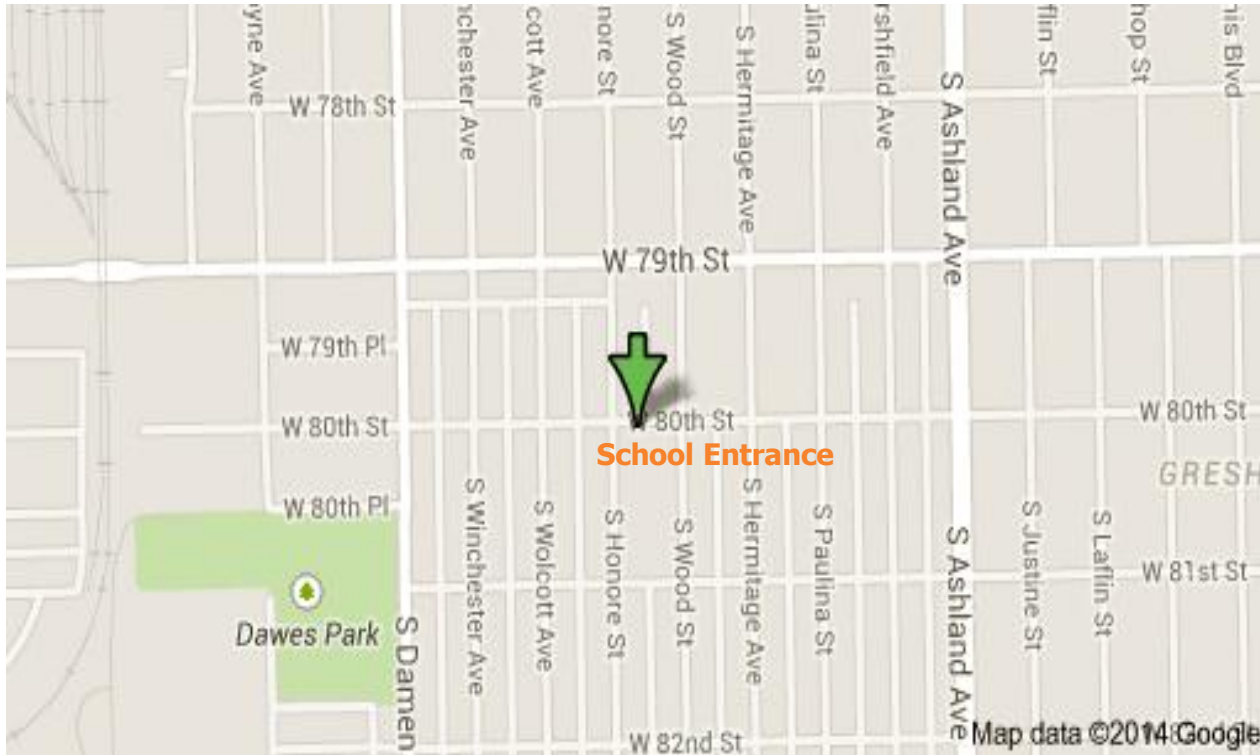



Getting There

- Address
 - **Ralph Ellison**
1817 W. 80th Street Chicago, IL 60620
- Public Transportation
 - Red line train towards 95th. Get off on 79th street. Take the #79 bus towards Ford City Mall. Get off on 79th and wood, walk east on wood and turn right on 80th street.
- Parking
 - At Ralph Ellison a parking lot is available directly across the street from the school's back entrance.
 - There is also street parking on the next block.
- Trip Details
 - Wednesday, December 11
 - Tentative time: TBD
- Entering the building
 - Front door faces Oakley Blvd.
 - Congregate in Main office (to the left of entrance stairs)
- **If lost, call Danielle**
 - 773 600 6432



Companies That Care

Urban Prep Bronzeville 521 E. 35th Street

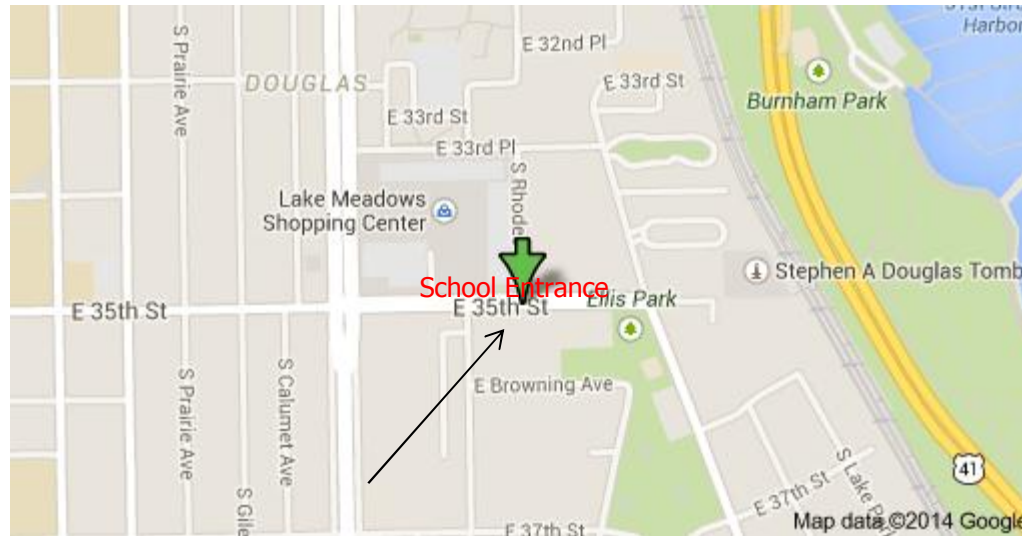



Getting There

- Address
 - **UP Bronzeville**
521 E. 35th Street
Chicago, IL, 60616
- Parking
 - At **Bronzeville**, there is a parking directly next to the school.
- Trip Details
 - Thursday, December 11th
 - Tentative time: TBD
- Entering the building
 - Front door faces 35th street and Rhodes.
 - Once you enter the building, Security will direct you to the main office.
- **If lost, call Danielle**
 - 773 600 6432



What To Expect

- Comments from previous attendees?
 - How was your experience? What did you learn?
 - How did this visit help you to better understand your mentee?
- Gain a better understanding of where you are needed most
- View your student's transcript and discuss his/her grades
 - Take part in our weekly Leadership Institute and debrief with your students



Next Steps

- Register using the link in the MMAHM or in your email (Will send out the link by December 1st.)
- Expect your event itineraries with more details. (Hope to have this to you by December 4th)
 - **Next Mentor Training:**
 - January 6th, 2015 – Freshman Induction

Have a safe and happy Thanksgiving holiday. Thank you for joining us!



Companies That Care

Questions?